

REMOVAL

1. REMOVE AIR CLEANER HOSE
2. REMOVE INTAKE AIR CONNECTOR ASSEMBLY (See page [EM-29](#))
3. DISCONNECT FUEL RETURN HOSE FROM FUEL PRESSURE REGULATOR

CAUTION:

Put a shop rag under the pressure regulator.

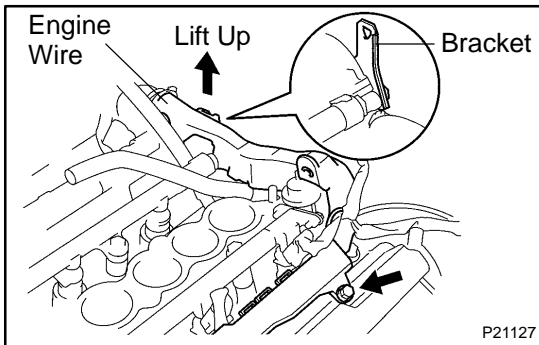

4. REMOVE FUEL PRESSURE REGULATOR

- (a) Remove holding bolt the engine wire to the LH cylinder head cover.
- (b) Disconnect the protector from the bracket on the RH cylinder head cover, and lift up the engine wire.

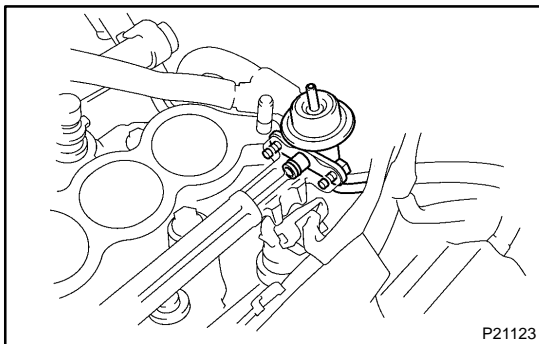

- (c) Remove the 2 bolts, and pull out the pressure regulator.
- (d) Remove the O-ring from the pressure regulator.